

ELIA AL - Accent LED



ELIA AL is a flush-mounting LED device for accent lighting in commercial areas and offices, composed of a white powder-coated die-cast aluminium frame and 2 different optics (36° and 60°) that guarantee a UGR of less than 19. The range is available in two sizes, with a colour temperature of 3,000K (warm white) or 4,000K (neutral white), a colour rendering index of more than 80 or more than 90 and the option of an electronic power supply with On/Off or DALI command. This modular flush-mounting solution features a rotosymmetrical optic equipped with a passive heat removal system, in die-cast aluminium. Installation is quick and easy, thanks to the reduced weight of the device, the bayonet coupling and the simple wiring, with the connector located on the device and remote power supply included.

GENERAL INFORMATION

Context	Office
Luminaire panoları	LED luminaire for accentuation
Unique digital code (Datamatrix)	Currently not present

Renk	Beyaz
Işık kaynağı tipi	LED - değiştirilemez
Sistem gücü	18 W
LED Lifetime	L80B50 (Tq25°) = 50.000h
Ağırlık (kg)	0.5
Garanti	5 yıl
Depolama sıcaklığı	-20° +65°
Operating temperature	-20° +45°

MATERIALS

Body	Alüminyum pres döküm
Ekran tipi	-
Optic	With high efficiency optic system
Gasket	-
Locking Hook	-
External screw	-
Colour	Powder coating

STANDARDS AND APPROVALS

Sınıflandırma	-
Yüzey sıcaklığı azaltılmış cihaz	-
DIN 18032-3 belgesi	-
IPEA	-
Yalıtım sınıfı	II
IP derecesi	IP40 - IP54
Direnç dayanıklı	IK06
Akkor Tel Deneyi:	850 °C

OPTIC AND ILLUMINATING FEATURES

Optik	60°
Unified Glare Rating	UGR<19
Lümen çıkışı (lm)	1700
Efficiency (lm/W)	94

Renk Sıcaklık	3000 K
Color Rendering Index	CRI 90
Standard Deviation Colour Matching	SDCM = 3
Photobiological Risk Class	RG0
Standart	-

ELETRICAL AND LIGHTING FEATURES

besleme voltaj	220-240 V
Nominal frekans (Hz)	50 / 60
Driver	Included
Driver failure rate	F025 = 50.000h Tq 25°C
Overvoltage protection	Overvoltage protection 0,5kV
Control System	ON OFF

INSTALLATION AND MAINTENANCE

Mouting and installation	Modular flush-mounting
Tilt	-
Wiring	With connection terminal on driver
Light souce replaceability	Not available
Controlgear replaceability	Not available
Driver Box	Independent driver unit
Rüzgara maruz maksimum yüzey	-

DIMENSIONAL

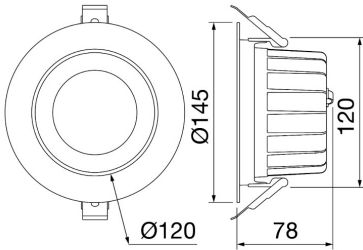

PHOTOMETRIC DISTRIBUTION

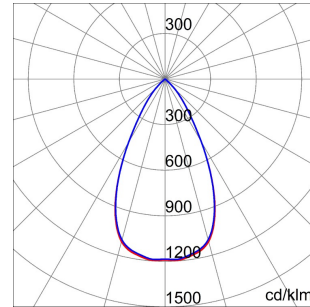

TECHNICAL SYMBOLOGY



IP

IP40 - IP54

IK

IK06

GWT

850 °C

STANDARDS/APPROVALS

Data, measures, designs and pictures are for information purpose only, last update 19/01/2022. They can be changed at any moment, therefore it is always recommended to read the last updated version published on the website www.gewiss.com. Lumen output and system power are subject to a tolerance of +/- 10%. Unless stated otherwise, the values apply to an ambient temperature of 25°C. Terms of warranty at <https://www.gewiss.com/it/en/company/landingpage/led-warranty>. - 1 of 2



Product Data Sheet
GWF1410GH930

ELIA AL - Accent LED

