

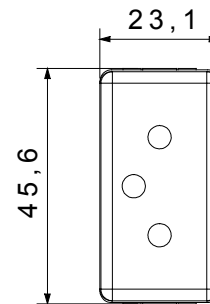

The System modular devices allow the creation of infinite combinations of devices and plates, through a complete range that covers all design, functional and installation needs. Colours and finishes: satin black, elegant and classy. Ideal for flush-mounted solutions (for rectangular or square boxes), surface-mounted solutions and special applications. The range includes control units, socket-outlets, breakers, indicators, connectors and devices for the control, safety and comfort of your home

| | | | |
|-----------------------------|-------------------------------|--|---------------------------------|
| Beschreibung | 2P+E - 10A - Typ 12 | Farbe | Schwarz |
| Spannung | 250 V ac | Schutzleiter-anschluss | - |
| Standard | Schweiz | Merkmale | - |
| Für Steckstifte | Ø 4 mm | Norm | IEC 60884-1 |
| Widerstand bei Prüfspannung | 2000 V bei 50 Hz für 1 Minute | Anzahl Betätigungen (Änderung Schaltstellung). | 10.000 bei In 250 V ac cosφ=0,8 |
| Kugeldruckprüfung | 125 °C | Glühdrahtprüfung | 850 °C |
| Haltekraft Klemme | > 50 N | Anschluss feindrätig (mm²) | min. 0,75 - max. 2x4 |
| Anschluss massiv (mm²) | min. 0,5 - max. 2x2,5 | Anz. SYSTEM Module | 1 |
| Material | Technopolymer | Electrocod | 0131 |

Abmessungen

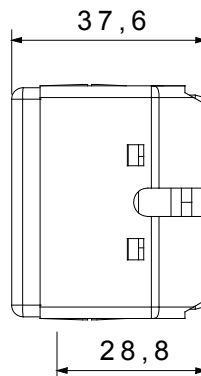
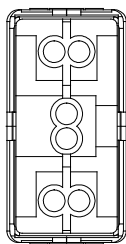

Technische Symbole



Normen / Richtlinien

