

The System modular devices make it possible to create infinite combination between devices and plates, thanks to a complete range that is able to satisfy all design, functional and installation requirements. Colour and finiture: glossy white, bright and versatile  
The range includes commands, socket- outlets, protection, indicators, connectors and devices for the control, safety and comfort of your home.

Category	Relay	Output contacts	10 AX 250V ac
Description	Step-step 2P	Colour	White
No. of poles	2	Voltage	230 V ac
Standard	EN 60669-1 / EN 60669-2-2	Frequency	50Hz
Resistance at test voltage	2000 V at 50 Hz for 1 minute	Insulation resistance	> 5 MOhm
Wiring terminals	With screw	Prolonged operation switch (no.of position changes)	40.000 at In 250 V ac cosφ=0,6
Thermo-pressure with ball	125 °C	Glow Wire Test	850 °C
Terminal grip on cable traction	> 50 N	Terminal tightening capacity stranded cables (mm <sup>2</sup> )	1x4 / 2x2,5
Terminal tightening capacity solid cables (mm <sup>2</sup> )	2x2,5	No. SYSTEM modules	1
Rated power (AC1)	0 VA	Rated power (AC15)	0 VA
230V incandescent/halogen lamps	800 W	Fluorescent lamps with electronic ballast	400 W
Fluorescent lamps with compensated ballast	360 W	CFL lamps	200 W
230V LED lamps	200 W	Halogen/LED lamps with electronic transformer	200 W
Halogen/LED lamps with electromechanical transformer	400 W	Material	Technopolymer
Electrocod	140		

### DIMENSIONAL

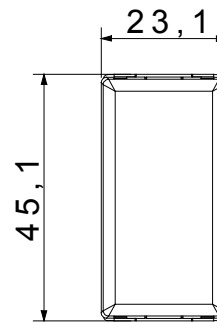
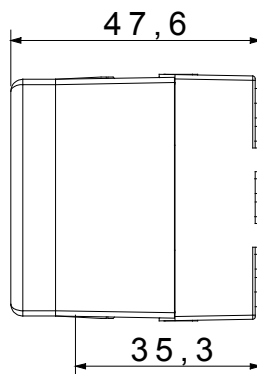
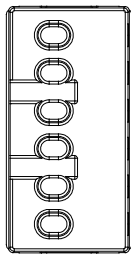

### TECHNICAL SYMBOLOGY



### STANDARDS/APPROVALS

