

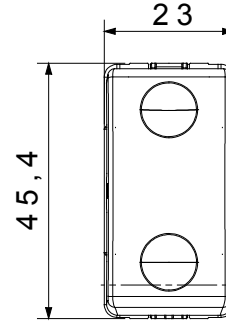

The System modular devices make it possible to create infinite combination between devices and plates, thanks to a complete range that is able to satisfy all design, functional and installation requirements. Colour and finiture: glossy white, bright and versatile
Ideal for flush-mounting solutions (for rectangular or square boxes), surface-mounting solutions, and for special applications. The range includes commands, socket- outlets, protection, indicators, connectors and devices for the control, safety and comfort of your home.

| | | | |
|--|------------------------------------|--|-----------------------|
| Categorie | Întreprupător | Butonul automat | Neutru |
| Simbol | | - Culoare | Alb |
| Descriere | 1P - 16AX | Tensiune | 250 V |
| Unitate de semnalizare | | - Standard | EN 60669-1 |
| Rezistența la tensiunea de test | 2000 V la 50 Hz timp de 1 minut | Puterea nominală a lămpilor cu LED 230V | 200 W |
| Rezistența izolației | >5 MOhm | Borne de cablare | Conținut |
| Comutator de funcționare prelungit (nr. de moduri de funcționare) | 40.000 la 250V c.a. $\cos\phi=0,6$ | Termo-presiune cu bilă | 125 °C |
| Test de încercare cu fir incandescent | 850 °C | Prinderea bornei la tracțiunea cablului | > 50 N |
| Capacitate de strângere borne cabluri torsadate (mm ²) | min. 0,75 - max. 2x4 | Capacitate de strângere a bornelor cabluri solide (mm ²) | min. 0,5 - max. 2x2,5 |
| Nr. Module DE SISTEM | 1 | Material | Tehnopolimer |
| Electrocod | 0130 | | |

DIMENSIONAL

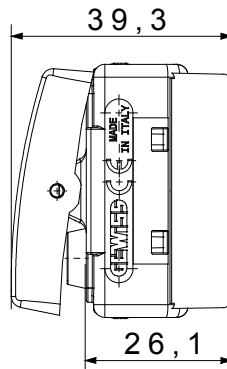
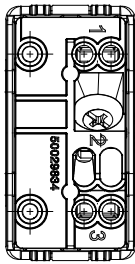

TECHNICAL SYMBOLOGY



STANDARDS/APPROVALS

