

# Product Data Sheet

## DX54012

DF Range



Straight and revolving coupling device for sheath with IP54 protection degree.

Colour	Grey RAL 7035	IP degree	IP54
ISO pitch	M 16x1.5	Sheath Ø (mm)	12
Type	Revolving	Electrocod	210

### DIMENSIONAL

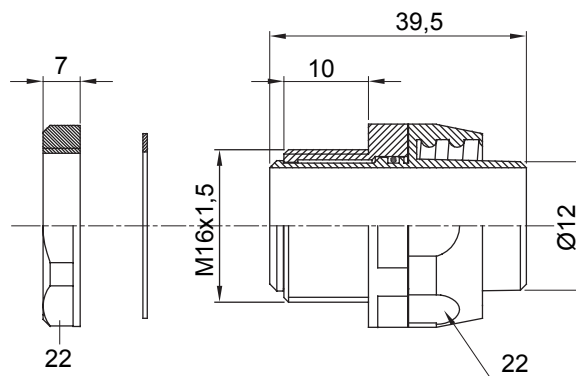

### TECHNICAL SYMBOLOGY

**IP**

IP54

### STANDARDS/APPROVALS

