



STADIUM PRO 3 is a high power LED floodlight, with an LES (light emitted surface) high emission, suitable for lighting sports facilities for professional competitive competitions. The spotlight has a graphite grey finish with trivalent treatment for maximum resistance to oxidation and is equipped with an integrated "self-cleaning" thermal dissipation system. It consists of three modules, each with a venting and non-condensing valve, protected from accidental impacts. The rotation system between the bracket and the optical modules is truncated-conical in aluminium with an integrated goniometer within the bracket for easy orientation control and fixing by means of a grub-screw, which ensure the tightness over time of each individual module. The spotlight is available in 4,000K or 5,700K colour temperatures and CRI>70, CRI>80 or CRI>90 (TLCI>80) colour rendering. The range also includes 6 types of circular optics, from 8° to 40°, 1 symmetrical/Elliptical optic and 2 asymmetric optics. The T.I.R.Ex optical system developed by GEWISS, with high transparency PMMA HT lenses, permits total control over the light beam, allowing for wide flexibility in the design environment, with high qualitative and quantitative performance. The power supply box can be fixed on the edge-bracket, or remotely, it is immune to surges of up to 10KV both in RCCB and common mode, with a single cable. The range includes a DALI2 or DMX-RDM power supply, to allow maximum flexibility in the creation of even complex light sets.

Stadium Pro is for a professional use hence the photometric data are not disclosed. We invite you to take contact with our technical and commercial teams.

| ALGEMENE INFORMATIE                              |   | OPTISCHE EN VERLICHTINGSKENMERKEN           |   |
|--|---|---|---|
| Context  | Professionele sportverlichting                    | Optiek                                      | Rond 40°  |
| Armatuur   | Krachtige LED schijnwerper                        | Unified Glare Rating                        | ULOR = 0%   |
| Toepassing                                       | Binnen / Buiten                                   | Lumen output (lm)                           | 118000  |
| Unieke digitale code (Datamatrix)                | Momenteel niet aanwezig                           | Effectiviteit (lm/W)                        | 81  |
| Kleur  | Grafietgrijs                                      | Kleur temperatuur                           | 5700 K  |
| Soort lichtbron                                  | LED   | Kleurweergave-index (CRI)                   | CRI>90 TLCI>80                                    |
| Systeem vermogen                                 | 1450 W  | Kleurconsistentie (SDCM)                    | SDCM = 3  |
| Levensduur led                                   | L90B10(Tq25 °C)=40.000u; L80B10 (Tq25 °C)=75.000u | Fotobiologisch risicoklasse                 | -   |
| Gewicht (kg)                                     | 30  | Standaard                                   | EN60598-1; EN60598-2-5; IEC 62471; IEC 62778      |
| Garantie   | 5 jaar  | ELEKTRISCHE EN VERLICHTINGSKENMERKEN        |   |
| Opslagtemperatuur                                | -   | Voeding voltage                             | Zie externe verzorgingseenheid                    |
| Bedrijfstemperatuur                              | -25 +50 °C  | Nominale frequentie (Hz)                    | Zie externe verzorgingseenheid                    |
| MATERIALEN                                       |   | Driver                                      | Moet afzonderlijk worden besteld                  |
| Behuizing  | Gegoten aluminium                                 | Uitvalpercentage driver                     | Zie externe verzorgingseenheid                    |
| Schildtype                                       | Vlak gehard glas 4 mm                             | Overspanningsbescherming                    | Zie externe verzorgingseenheid                    |
| Optiek   | T.I.R.Ex. Optisch PMMA HT                         | Besturingssysteem                           | Zie externe verzorgingseenheid                    |
| Pakking  | Anti-aging silicone                               | INSTALLATIE EN ONDERHOUD                    |   |
| Slothaak   | -   | Montage en installatie                      | Lichtmast - Oppervlakte                           |
| Externe schroef                                  | Rvs   | Helling                                     | Rotatie op beugel met geïntegreerde goniometer    |
| Kleur  | Polyester poedercoating                           | Bedrading                                   | Multipolaire kabel tussen schijnwerper en voeding |
| NORMEN EN GOEDKEURINGEN                          |   | Bevestiging                                 | Beugel  |
| Classificatie                                    | -   | Vervangbaarheid lichtbron                   | Door professional                                 |
| Apparaat met gereduceerde oppervlaktetemperatuur | -   | Vervangbaarheid verdeelinrichting           | Door professional                                 |
| DIN 18032-3 certificering                        | Beschikbaar                                       | Driver box                                  | Extern  |
| IPEA   | -   | Maximaal oppervlak blootgesteld aan de wind | 0,36 m²   |
| Isolatie klasse                                  | I   |   | -   |
| IP graad   | IP66  |   | -   |
| Mechanische weerstand                            | IK08  |   | -   |
| Gloeidraadtest                                   | -   |   | -   |

## DIMENSIONAL

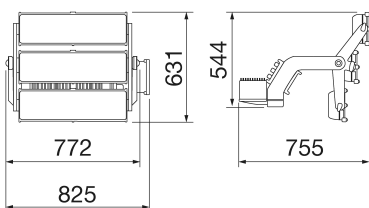

## PHOTOMETRIC DISTRIBUTION

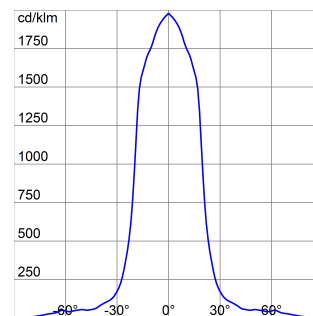

#### TECHNICAL SYMBOLOGY



**IP**  
IP66

**IK**  
IK08

**GWT**  
-

#### STANDARDS/APPROVALS

