

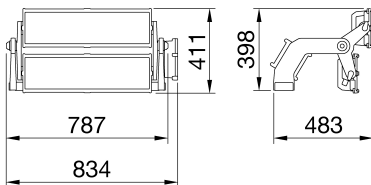

Spatium PRO | 2 is a high-power LED floodlight, with a high-emittance LES (light emitted surface), suitable for lighting professional and semi-professional sporting facilities. The floodlight has a graphite grey finish with trivalent treatment for maximum resistance to oxidation and is equipped with an integrated 'self-cleaning' heat dissipation system. It consists of 2 modules, each with a bleed and anti-condensation valve, protected from accidental impact. The rotation system between the brackets and optic modules is of the truncated-conical aluminium type, with an integrated goniometer in the bracket for easy control of orientation, and screw and grub screw fastening, which guarantees the fastness of each individual module over time. The floodlight is available in the following colour temperatures 4,000K or 5,700K and colour rendering CRI>70, CRI>80 or CRI>90 (TLCI>80). In addition, the range offers 6 types of circular optics, from 8° up to 40°, 1 symmetrical/elliptical optic and 2 asymmetric optics. The T.I.R.Ex. optic system developed by GEWISS with lenses in PMMA HT (high-transparency), gives complete control over the light beam, allowing for great flexibility in any project design, with high qualitative and quantitative performance. The power supply box can be installed on the bracket or remote, and is protected from surges up to 10KV, either in differential or common mode, with a single cable. The range requires a DALI2 or DMX-RDM power supply to permit the greatest flexibility in the creation of lighting scenarios, even of great complexity.

| ALGEMENE INFORMATIE                              |   | OPTISCHE EN VERLICHTINGSKENMERKEN           |  |
|--|---|---|--|
| Context  | Professionele sportverlichting                    | Optiek                                      | Asymmetrisch 60°   |
| Armatuur   | Krachtige LED schijnwerper                        | Unified Glare Rating                        | ULOR = 0%  |
| Toepassing                                       | Binnen / Buiten                                   | Lumen output (lm)                           | 99000  |
| Unieke digitale code (Datamatrix)                | Momenteel niet aanwezig                           | Effectiviteit (lm/W)                        | 103  |
| Kleur  | Grafietgrijs                                      | Kleur temperatuur                           | 4000 K   |
| Soort lichtbron                                  | LED   | Kleurweergave-index (CRI)                   | CRI70  |
| Systeem vermogen                                 | 960 W   | Kleurconsistentie (SDCM)                    | SDCM = 5   |
| Levensduur led                                   | L90B10(Tq25 °C)=40.000u; L80B10 (Tq25 °C)=75.000u | Fotobiologisch risicoklasse                 | -  |
| Gewicht (kg)                                     | 18  | Standaard                                   | EN60598-1; EN60598-2-5; IEC 62471; IEC 62778                 |
| Garantie   | 5 jaar  | ELEKTRISCHE EN VERLICHTINGSKENMERKEN        |  |
| Opslagtemperatuur                                | -   | Voeding voltage                             | Zie externe verzorgingseenheid                               |
| Bedrijfstemperatuur                              | -25 +50 °C  | Nominale frequentie (Hz)                    | Zie externe verzorgingseenheid                               |
| MATERIALEN                                       |   | Driver                                      | Moet afzonderlijk worden besteld                             |
| Behuizing  | Gegoten aluminium                                 | Uitvalpercentage driver                     | Zie externe verzorgingseenheid                               |
| Schildtype                                       | Vlak gehard glas 4 mm                             | Overspanningsbescherming                    | Zie externe verzorgingseenheid                               |
| Optiek   | T.I.R.Ex. Optisch PMMA HT                         | Besturingssysteem                           | Zie externe verzorgingseenheid                               |
| Pakking  | Anti-aging silicone                               | INSTALLATIE EN ONDERHOUD                    |  |
| Slothaak   | -   | Montage en installatie                      | Lichtmast - Oppervlakte                                      |
| Externe schroef                                  | Rvs   | Helling                                     | Rotatie op beugel met geïntegreerde goniometer               |
| Kleur  | Polyester poedercoating                           | Bedrading                                   | Waterdichte connector tussen schijnwerper en voedingseenheid |
| NORMEN EN GOEDKEURINGEN                          |   | Bevestiging                                 | Beugel   |
| Classificatie                                    | -   | Vervangbaarheid lichtbron                   | Door professional  |
| Apparaat met gereduceerde oppervlaktetemperatuur | -   | Vervangbaarheid verdeelinrichting           | Door professional  |
| DIN 18032-3 certificering                        | Beschikbaar                                       | Driver box                                  | Extern   |
| IPEA   | -   | Maximaal oppervlak blootgesteld aan de wind | 0,24 m2  |
| Isolatie klasse                                  | I   | -   | -  |
| IP graad   | IP66  | -   | -  |
| Mechanische weerstand                            | IK08  | -   | -  |
| Gloeidraadtest                                   | -   | -   | -  |

### DIMENSIONAL



### PHOTOMETRIC DISTRIBUTION

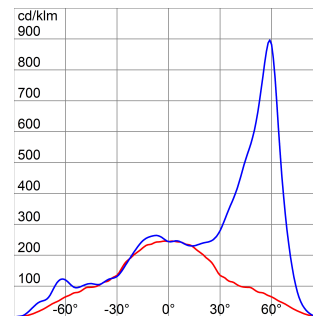



# Product Data Sheet

## GWP3231AC740

STADIUM PRO

### TECHNICAL SYMBOLOGY



  
0,24 m2



**IP**  
IP66

**IK**  
IK08

**GWT**  
-

### STANDARDS/APPROVALS

