



Omschrijving Switch disconnector with accessory option

Code 90 AM-serie

Aantal

polen 4P

Nominale

stroom 40 A

AC Rated operational voltage (Ue) 415 V

ELECTRICAL CHARACTERISTICS

ELECTRICAL CHARACTERISTICS		MECHANICAL CHARACTERISTICS	
Standaard	EN 60947-3	Mechanical life	20.000 maneuvers
Nominale isolatie-spanning (Ui)	500 V	Screwdriver suggested	PZ2
Nominale stoot-houdspanning (Uimp)	4 kV	Nominaal aandraaimoment	3 Nm
Nominale frequentie (Hz)	50/60 Hz	Max rigid cable section	≤ 1x35 mm ² - ≤ 2x16 mm ² - ≤ 1x16 + 2x10 mm ²
Gebruik categorie	AC-23A	Max. section flex. cables	≤ 1x35 mm ² - ≤ 2x16 mm ² - ≤ 1x16 + 2x10 mm ²
Rated short-time withstand current for 1s (Icw)	800 A	IP- graad	IP20
Power dissipation per pole	2,8 W	Bedrijfs- temperatuur	-25°C + +60°C
Electrical endurance	5.000 maneuvers	Tropicalization	55°C - UR 95%
-	-	Upline/downline power supply	Si
-	-	Biconnection (cable + fork combs)	Yes (upstream and downstream)
-	-	Vergrendelbaar	Yes, with GW96041

DIMENSIONAL

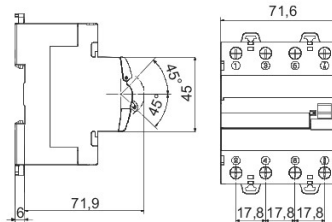

STANDARDS/APPROVALS

