

ELIA HL



ELIA HL is an LED highbay designed for indoor industrial, logistics and tertiary applications, where efficiency, high luminous output, precision and resistance are required. Available in 3 power steps (120 W, 150 W and 200 W) with a standard colour temperature of 4,000 K (neutral white) and a colour rendering index of 80, the range allows for great flexibility with its multiple possible combinations: 3 optics options (60°, 90° and 120° beam angles in polycarbonate lenses) and 2 integrated power supply options (On/Off and DALI). The luminaire can be suspension-mounted through the hook attachment integrated into the upper part of the device, and thanks to its black powder-coated die-cast aluminium body with incorporated heatsink, it is tough, durable (IP65 and IK08) and able to withstand harsh environmental conditions (such as ambient temperature variations from -30°C to +50°C).

GENERAL INFORMATION

Context	Industry and logistics lighting
Luminaire	High-power LED luminaire
Toepassing	Intern
Unique digital code (Datamatrix)	Currently not present
Kleur	Zwart
Type lichtbron	LED
System vermogen	200 W
LED Lifetime	L80B50 (Tq=25°C) > 100.000 h
Gewicht (kg)	3.9
Garantie	5 jaar
Opslagtemperatuur	-40° +85°

OPTIC AND ILLUMINATING FEATURES

Optiek	90°-
Unified Glare Rating	-
Lumen-vermogen (lm)	30300
Efficacy (lm/W)	152
Kleur temperatuur	4000 K
Colour Rendering Index	CRI 80
Standard Deviation Colour Matching	SDCM = 5
Photobiological Risk Class	RG0
Standaard	EN 60598-1; IEC/TR 62778; EN 62493

OPERATING TEMPERATURE

Operating temperature	-30° +50°
-----------------------	-----------

ELETRICAL AND LIGHTING FEATURES

Voedings-spanning	100-240 V
Nominale frequentie (Hz)	50/60 Hz
Driver	Ingebouwd

MATERIALS

Body	Gietaluminium
Type plaat	-
Optic	Polycarbonate lens
Gasket	-
Locking Hook	-
External screw	Stainless steel
Colour	Powder coating

Driver failure rate	F10 (Tq=25°C) = 65.000 h
Overvoltage protection	DM 4 kV/ CM 6 kV
Control System	ON / OFF

INSTALLATION AND MAINTENANCE

Mounting and installation	Hanging
Tilt	-
Wiring	With power cable
Bevestiging	Via hoist ring at the top of the luminaire
Light source replaceability	Non-replaceable
Controlgear replaceability	By professional

STANDARDS AND APPROVALS

Classificering	-
Toestel met verlaagde oppervlaktetemperatuur	-
DIN 18032-3-certificering	Not available
IPEA	-
Isolatie-klasse	I
IP-graad	IP65
Stootbestendigheid	IK08
Glow Wire Test	750 °C

Driver Box	-
Maximum surface exposed to the wind	-

DIMENSIONAL

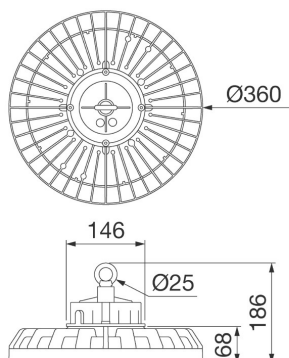

PHOTOMETRIC DISTRIBUTION

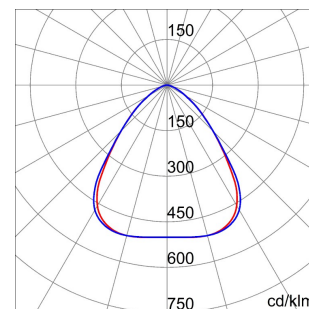

ELIA HL

TECHNICAL SYMBOLOGY



IP
IP65

IK
IK08

GWT
750 °C

STANDARDS/APPROVALS

